

# 25.6 Scenic Acres in Milaca for SALE \$47,777

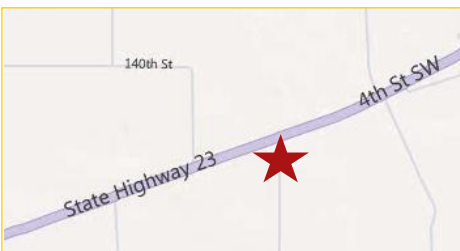

## County Road 5 Milaca, MN

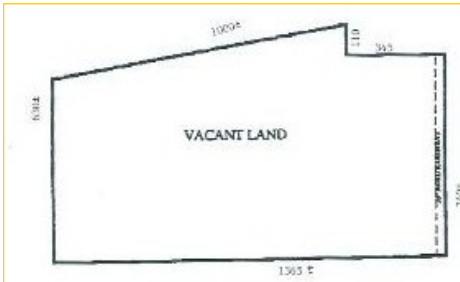

Last Updated: Tuesday, May 10, 2011

## High Rolling Property Close to City Limits—Lots of Potential!

### Great investment opportunity

Located on the western edge of Milaca, this 25.6 acre parcel is high and rolling. Originally planned to be 2.5 acre residential lots, the city is open to extending water and sewer to the site.

Milaca is a quaint, rural community and is the governmental hub for Mille Lacs County. The city is home to the county government center, Heggie's Pizza, Fair-view Clinic, Elim Nursing facility, Milaca Public Schools and its own Municipal Airport. Priced right to build your dream home!

The information herein was obtained from sources deemed to be reliable. The information includes projections, assumptions and estimates as examples only and of a forecast nature yet may not represent actual, current or future performance. We make no guarantees or warranties. It is submitted subject to the possibility of withdrawal without notice, errors, change of price, omissions, financing, rental or other conditions. You and your tax and legal advisors should conduct your own investigation of the property and contemplated or proposed transactions. Copyright 2011 ROCK SOLID Commercial.

# Rock Solid COMMERCIAL

*Providing Exceptional Personal Service*

[www.rocksolidcommercial.com](http://www.rocksolidcommercial.com)

*Delivering Exceptional Positive Results*

**ROCK SOLID Companies  
is Your FULL SERVICE  
Real Estate Brokerage**

Commercial, Property Management,  
Troubled Assets, Court Receivership,  
Investment/Equity, 1031 Exchange  
Residential, Property Development  
and Vacation/Coastal Properties.

Licensed in Minnesota & Florida

Contact:

# Ron Touchette

Broker

# 612.435.7777

[ron@rocksolidcommercial.com](mailto:ron@rocksolidcommercial.com)

7044 E. Fish Lake Rd., Maple Grove, MN 55311 Main: 612.435.7770 Fax: 612.435.7771